



SURF ALLAMANDA DP 3



SURF ALLAMANDA is a GPA design, diesel electric, DP 3, multipurpose subsea services support vessel with twin AHC deep water cranes, triple stern drive azimuth propeller, triple bow propeller and accommodation for 105 persons.

The vessel is designed for world-wide, deep water operations to fulfill the following duties:

- Deepwater precision lifting and installation up to 3,000m;
- ROV operations;
- Maintenance of SPMs buoys;
- Platform maintenance support in DP;
- Methanol transport;
- Flotel support;
- Rescue operations / Firefighting

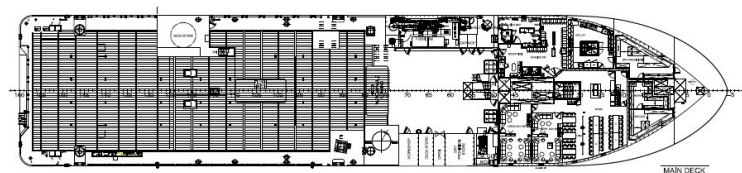
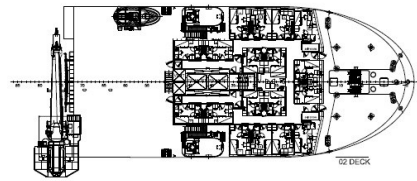
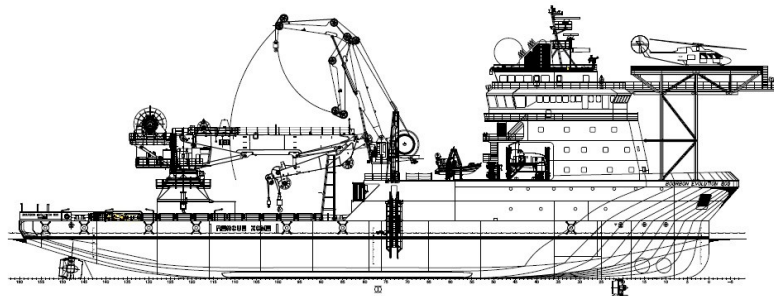

M U L T I P U R P O S E S U P P L Y V E S S E L

REGISTRATION

Vessel Name: **SURF ALLAMANDA**

Flag: **INDONESIAN**

Class: **BV I * HULL * MACH, Oil Recovery Ship, Chemicals products, Oil products, Special service/Stand by rescue Vessel (150 survivors in tropical area) Fire-Fighting Ship 1 - Water Spraying, unrestricted navigation ; * AUT-UMS, * ALM, * DYNAPOS-AM/AT-RS, + SDS, COMF-NOISE 2, COMF-VIB 1, CLEANSHIP SUPER 7+**

Builder: **Zhejiang Shipbuilding Co.**

Year Built: **2010**

Updated: 10-12-2015



TECHNICAL SPECIFICATIONS

MPSV - SURF ALLAMANDA



MAIN PARTICULARS

DIMENSIONS

Length between PP:	95.60 m
Breadth moulded:	21.00 m
Depth:	8.00 m
Draft (Min / Max):	5.40 m / 6.00 m
Deadweight at max. draft:	4,858 t
Gross tonnage:	6,000 UMS
Moonpool:	8 m x 8 m (not opened - option)
Helideck (Diam/Tonnage):	19.5 m / 11 t

CAPACITIES & DELIVERY RATES

Deck area:	940 m ² @ 5t/m ² & 10 t/m ² (aft frame 128)
Mezzanine deck area:	230 m ² @ 1.4 t/m ² +reinforced beams
Deck cargo (transit - operations):	2,000 t - 1,300 t
Fuel oil (capacity - transfer):	1,096 m ³ - 150 m ³ /h @ 7 bars
Drill or Water ballast (capacity - transfer):	2,508 m ³ - 150 m ³ /h @ 7 bars
Antiroll passive tanks:	NA
Antiheeling (capacity - transfer):	750 m ³ - 2 x 1,500 m ³ /h
Fresh water(capacity - transfer):	946 m ³ - 150 m ³ /h @ 7 bars
Mud / Brine (capacity - transfer):	NA
Methanol (capacity - transfer):	2 x 187 m ³ - 2x 100 m ³ /h @ 9 bars
Dry bulk (capacity - transfer):	NA
Other:	NA
Oil recovery:	300 m ³
Dispersant:	5 m ³

ACCOMMODATIONS

Accommodations for:	105 persons
Single cabins:	33
2 men cabins:	36
3 men cabins:	NA
4 men cabins:	NA
6 men cabins:	NA
Offices:	4
Hospital:	1
Mess / Day rooms:	1 Mess / 2 Day rooms
Laundry:	4
Galley:	1
Workshop:	2
Other:	NA
Air conditioning:	YES
Water maker:	2 evaporators - 2 x 4m ³ /day (DP Mode)

MACHINERY & PERFORMANCE

PROPULSION - MACHINERY

Main propulsion:	3 x 1,686 kW FP Azimuth thrusters
Bow thrusters:	2 x 843 kW FP tunnel
Bow thruster retractable:	1 x 843 kW Azimuth
Main generator:	6 x 1,235 kW - 600 V
Auxiliary generator:	1 x 1,235 kW - 480 V
Emergency generator:	1 x 170 kW - 480 V

SPEED & CONSUMPTION (Information only)

Maximum speed (100%) lighth vessel:	12 knots - 26 t/day
Service speed (80%) medium loaded:	10 knots - 18 t/day
Stand-by at port:	3 t/day
Stand-by on DP:	10 t/day

EQUIPMENT & ELECTRONICS

DECK EQUIPMENT

Tuggers:	1 x 15 t
Capstans:	2 x 10 t
Deck service air supply:	1,200 m ³ /h @ 6.5 bars
Deck power supply:	2 x 500 kW - 480 V
Work boat:	NA
Deck provision crane:	NA
Mooring:	NA
Offshore crane 1:	Hydramarine knuckle boom
Harbour capacity:	DAF 1.2 - 150 t @ 10 m - 35 t @ 35 m
Offshore capacity:	DAF 1.4 - 150 t @ 10 m - 25 t @ 35 m
Main winch:	150 t / 87 t - 2,500 m - AHC
Auxiliary winch:	20 t / 10 t - 2,500 m - AHC - Man Riding
Offshore crane 2:	SMST knuckle boom
Harbour capacity:	DAF 1.3 - 40 t @ 9.5 m - 15 t @ 21.5 m
Offshore capacity:	DAF 1.6 - 30 t @ 9.5 m - 11 t @ 21.5 m
Main winch:	40 t / 17 t - 2,500 m - AHC - Man Riding
Auxiliary winch:	NA

COMMUNICATION

Inmarsat:	2 x SatC
VSAT:	2 x Ku band 128 Kbit
Video network:	YES
Telephone in all cabins:	YES
Video connection in all cabins:	YES

DYNAMIC POSITIONING

Maker:	CONVERTEAM
Type:	DP 3
Reference 1:	DGPS Fugro Seastar
Reference 2:	DGPS Fugro Seastar
Reference 3:	DGPS Thales Aquarius
Reference 4:	Sonardyne Ranger USBL
Reference 5:	Cyscan Laser Reference

SAFETY EQUIPMENT

Fi-Fi:	Class 1
Pumps:	2 x 1,200 m ³ /h
Monitors:	2 x 1,200 m ³ /h
Fast Rescue Craft:	1 Mare Safety GRP600
Rescue Capacity:	150 persons in tropical area

All particulars believed to be correct but not guaranteed